

SCALA 1/200
0 2m 4m 6m 8m 10m 12m

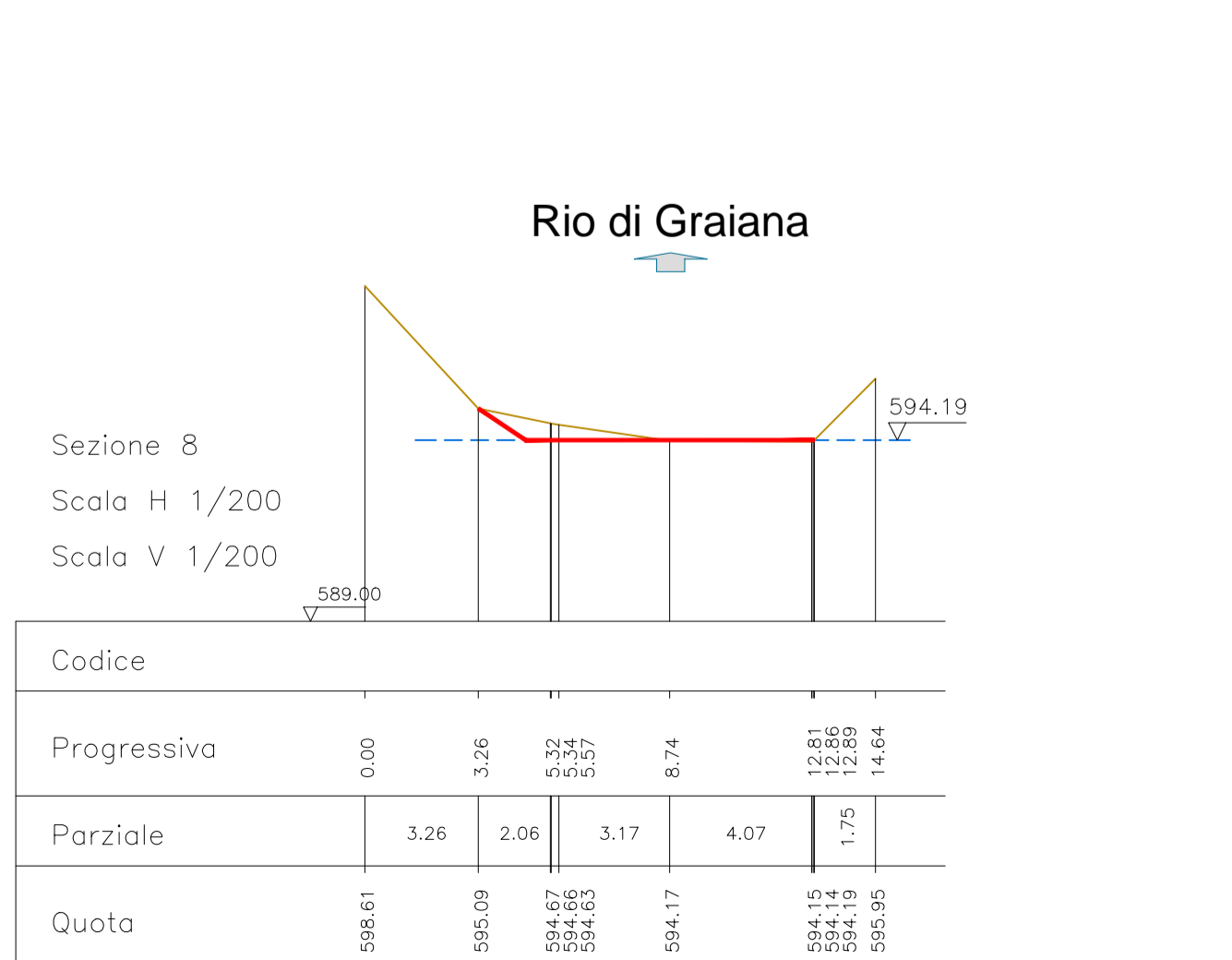
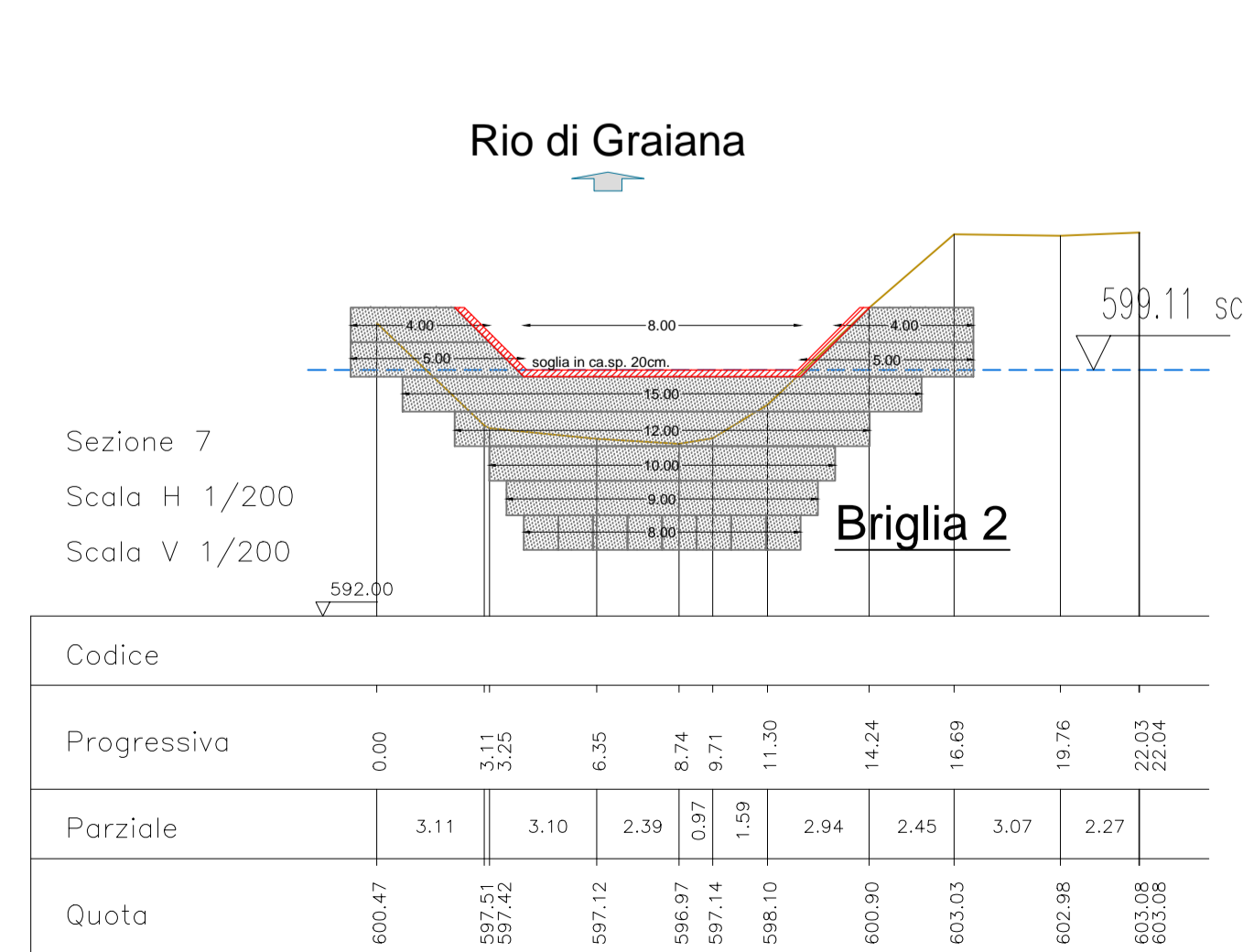
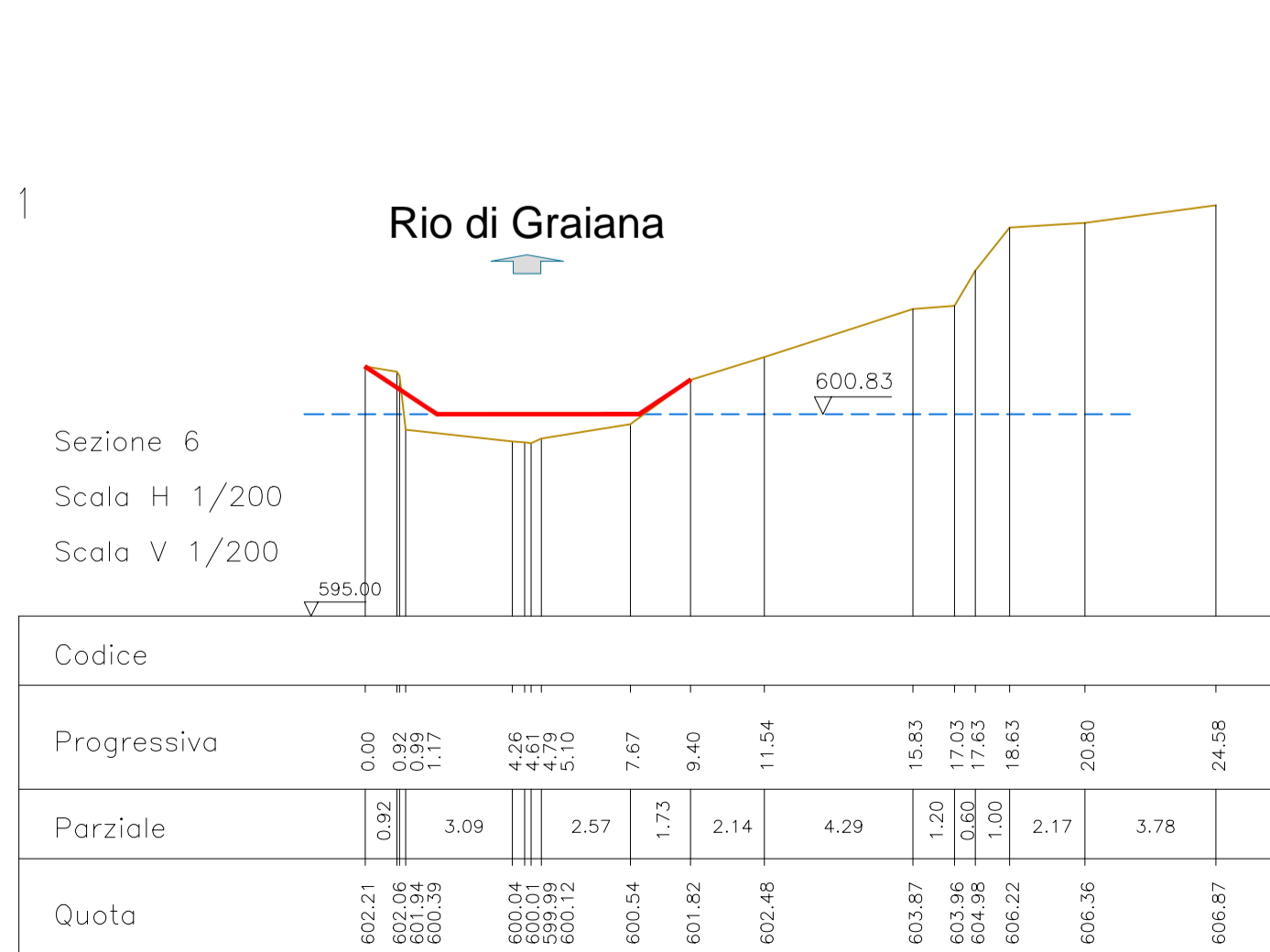
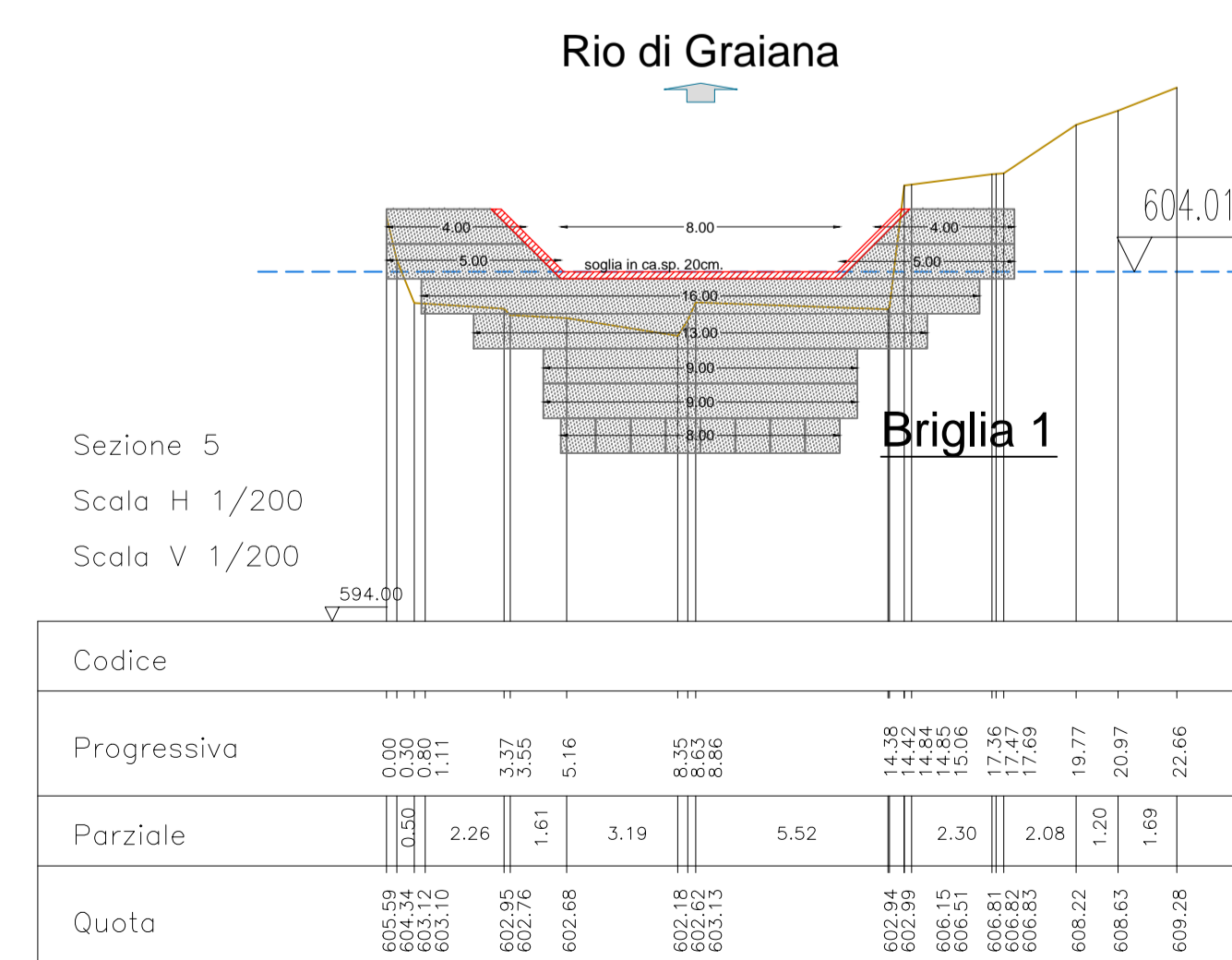
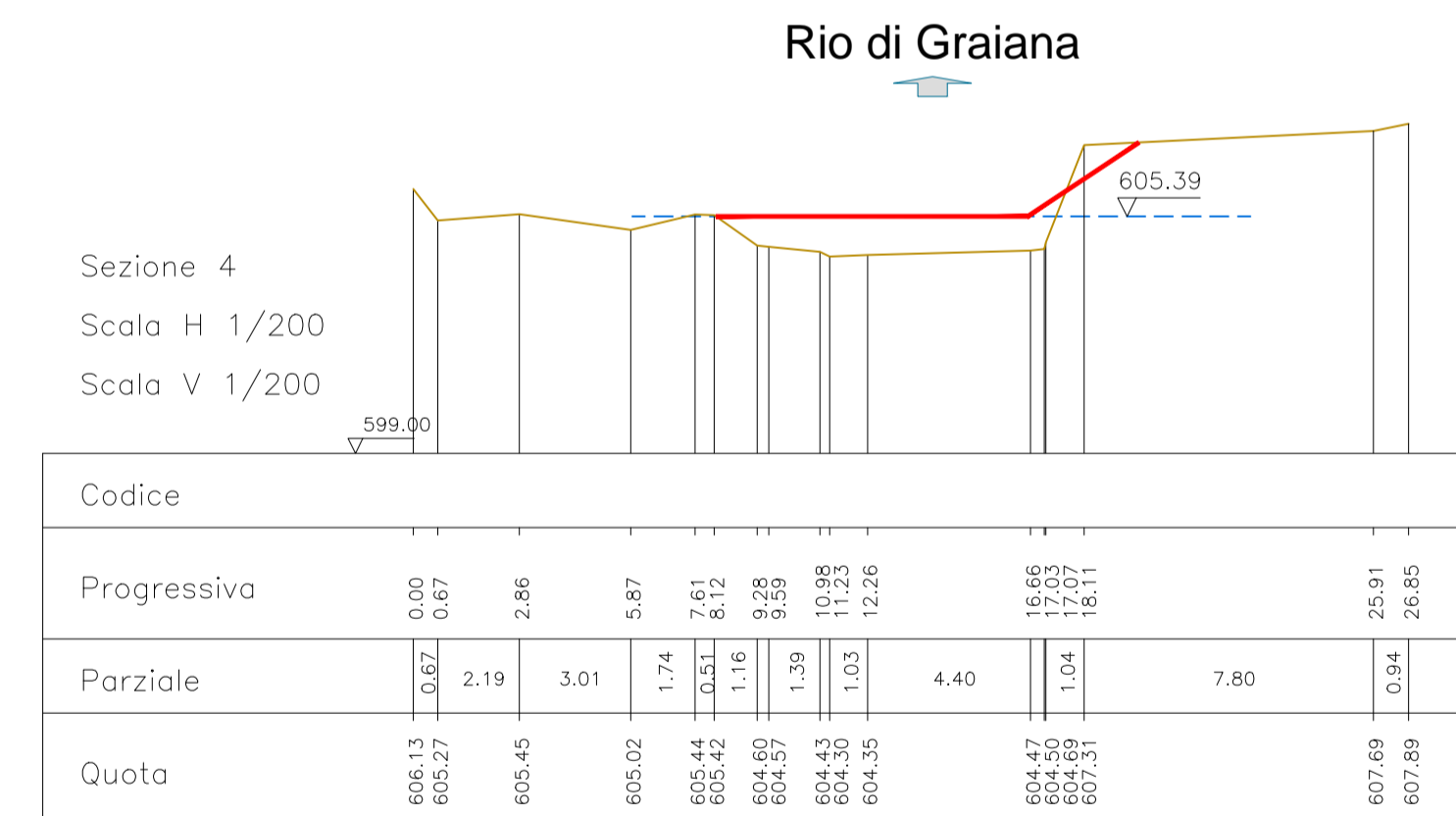
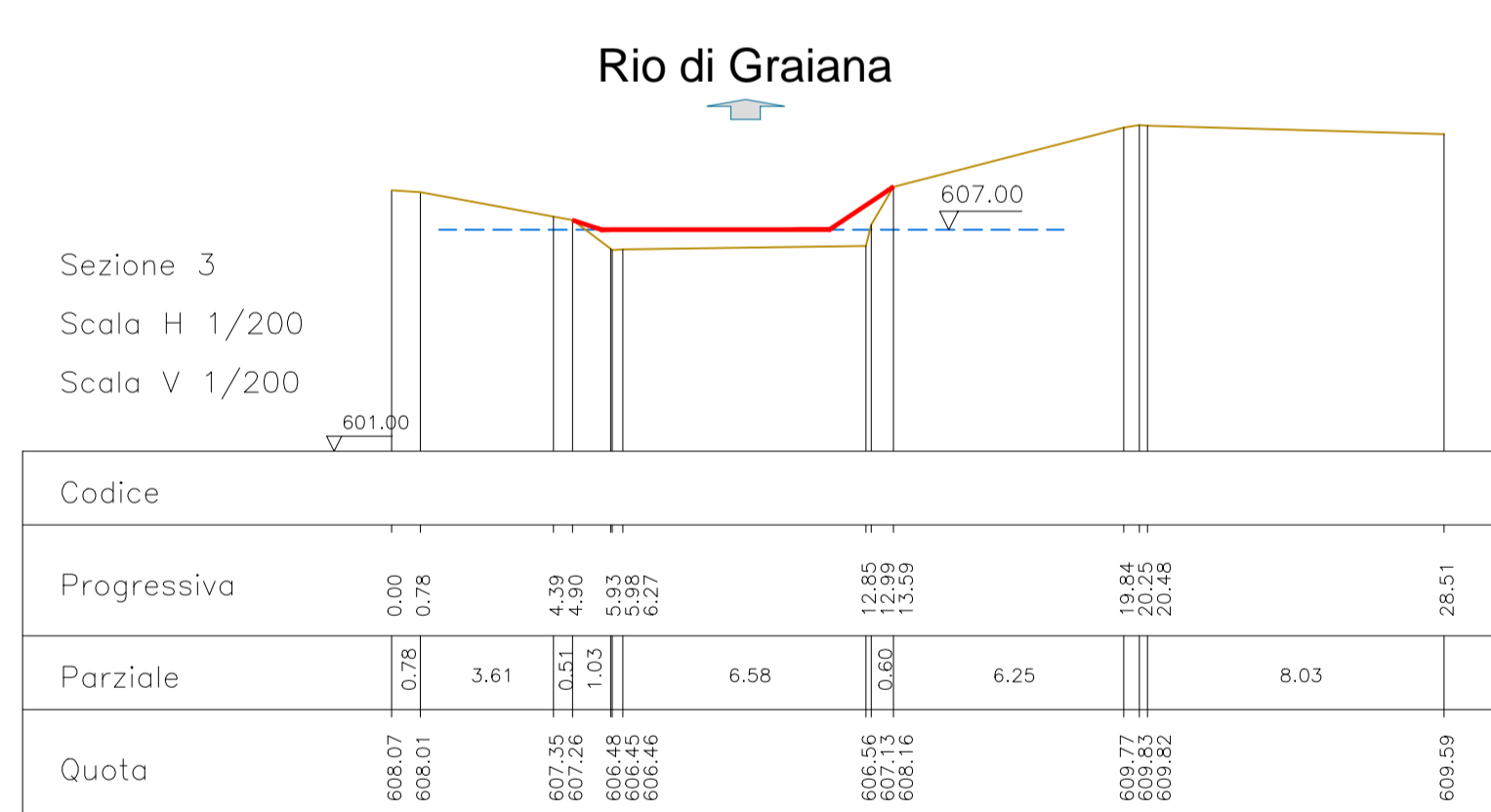
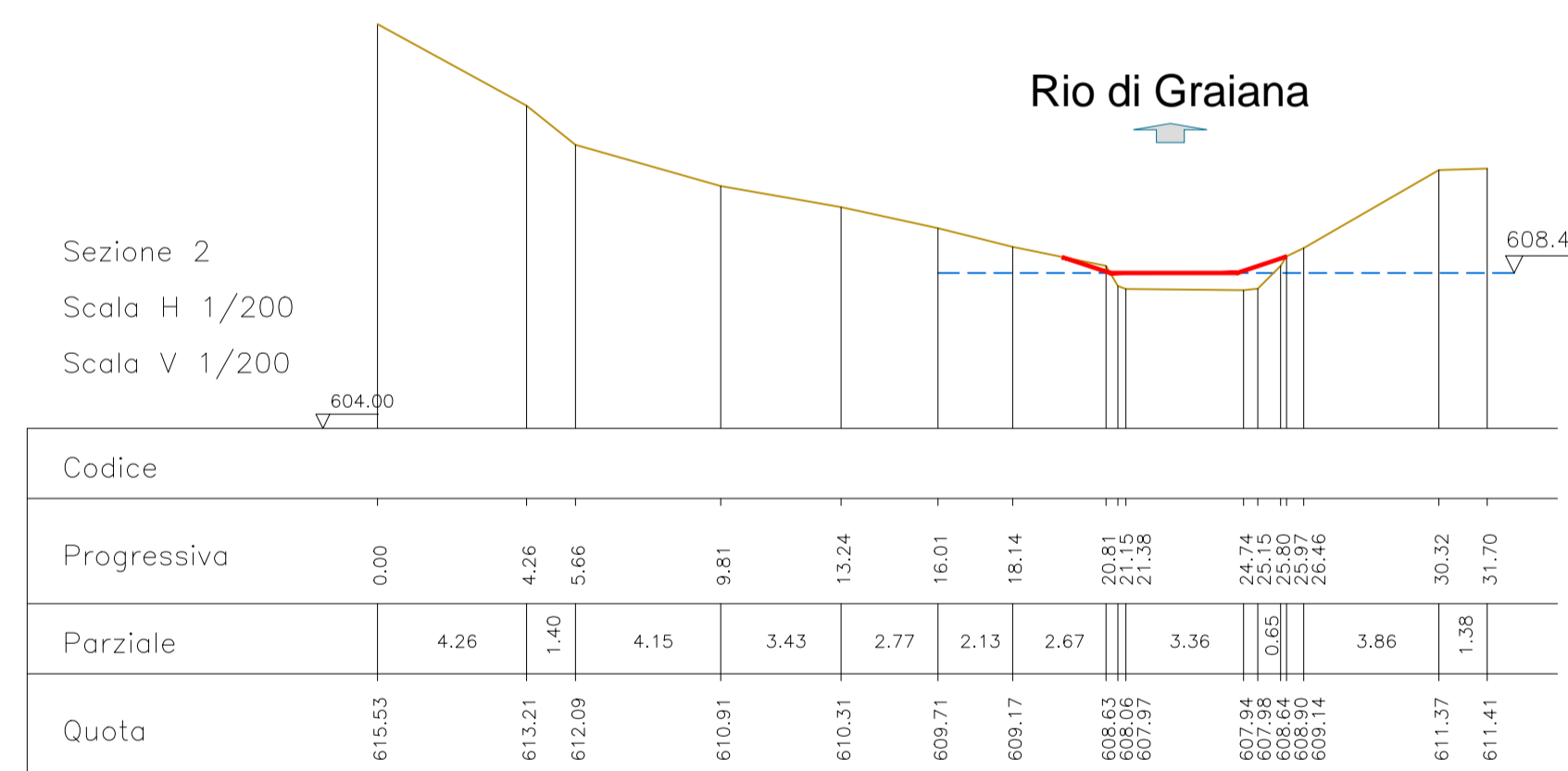
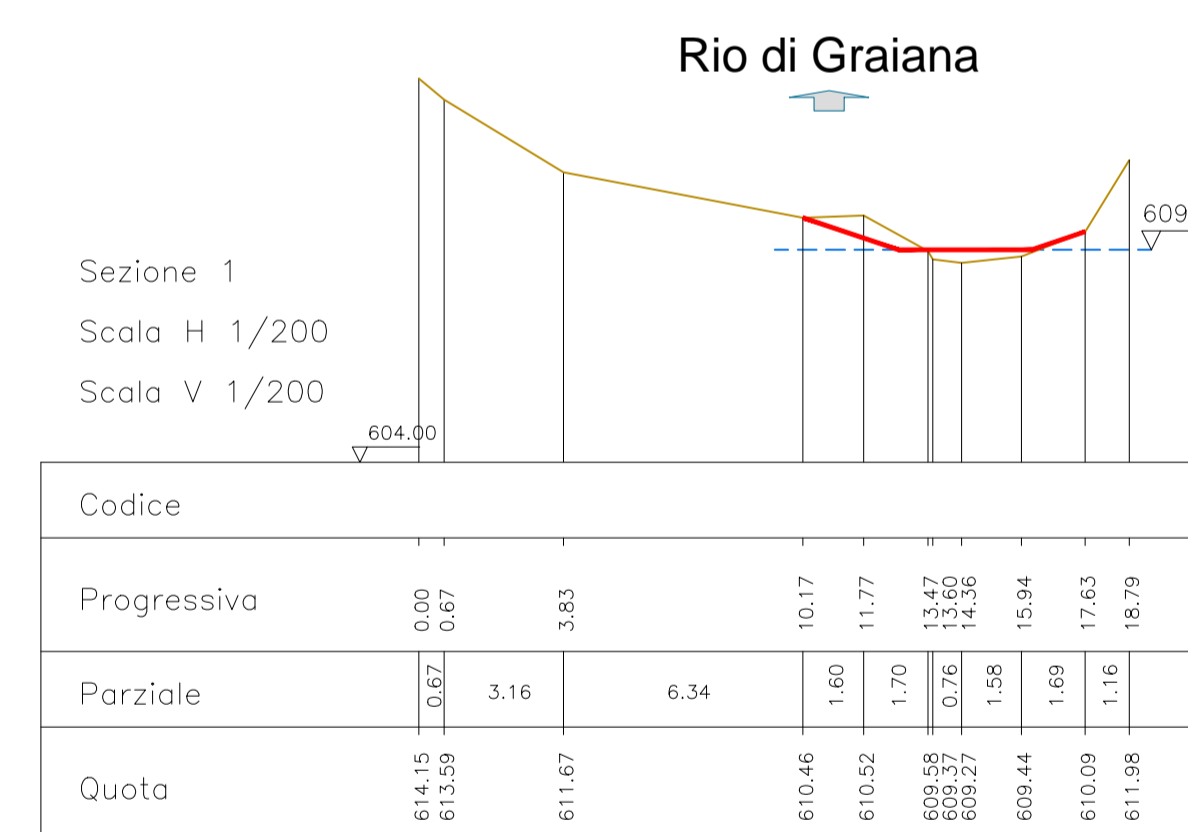
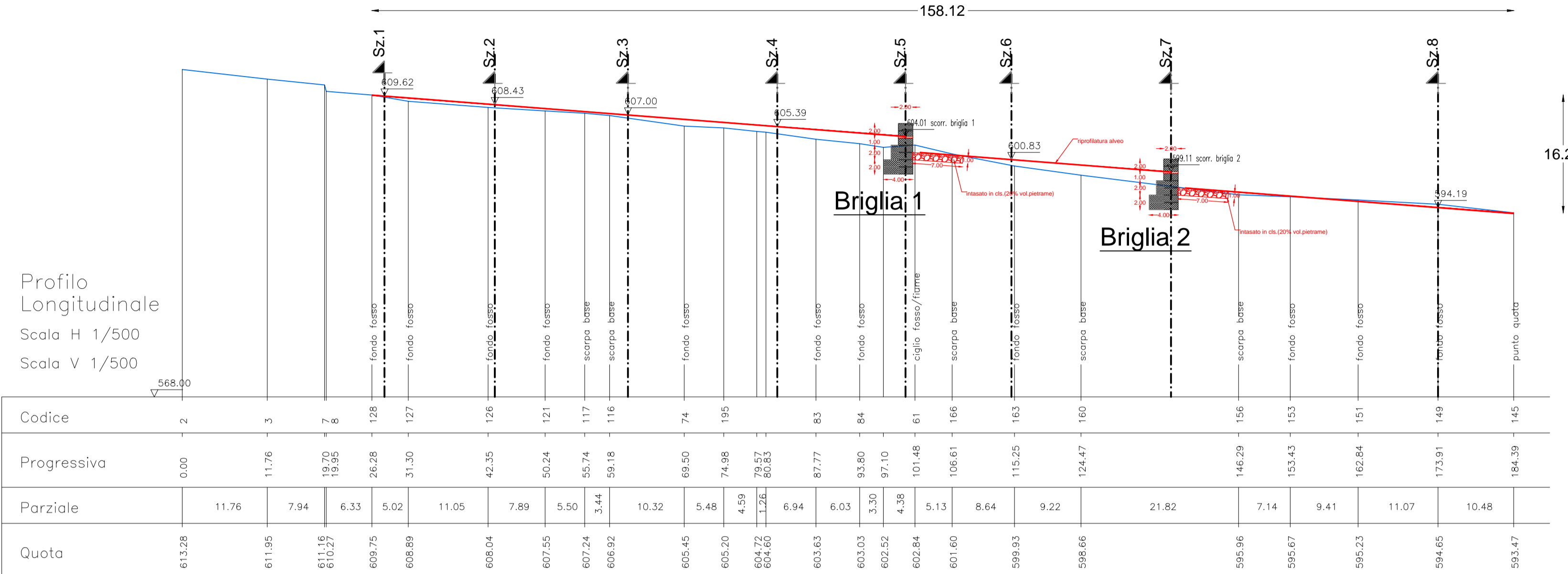
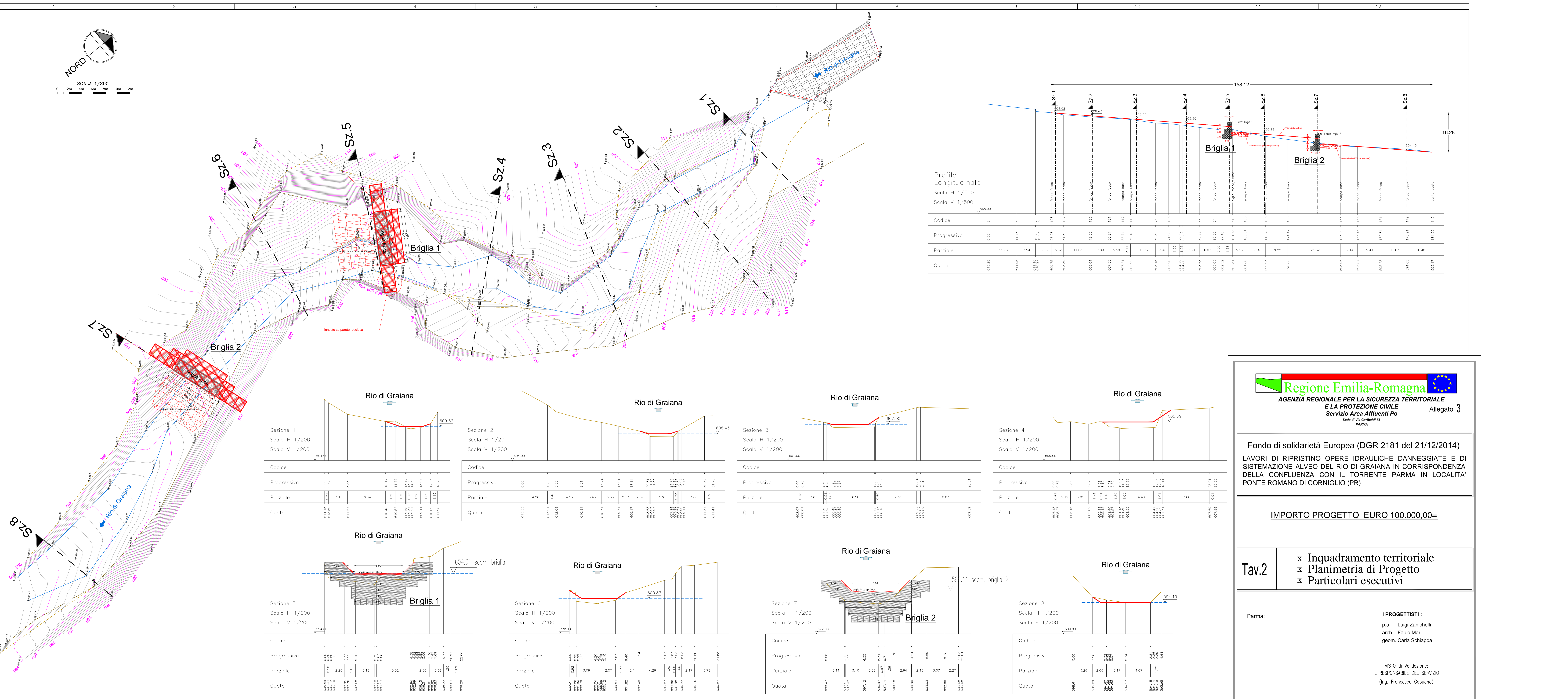

Fondo di solidarietà Europea (DGR 2181 del 21/12/2014)
LAVORI DI RIPRISTINO OPERE IDRAULICHE DANNEGGIATE E DI SISTEMAZIONE ALVEO DEL RIO DI GRAIANA IN CORRISPONDENZA DELLA CONFLUENZA CON IL TORRENTE PARMA IN LOCALITA' PONTE ROMANO DI CORNIGLIO (PR)

IMPORTO PROGETTO EURO 100.000,00=

Tav.2
 Inquadramento territoriale
 Planimetria di Progetto
 Particolari esecutivi

Parma: I PROGETTISTI:
p.a. Luigi Zanichelli
arch. Fabio Mari
geom. Carla Schiappa

VISTO di Validazione:
IL RESPONSABILE DEL SERVIZIO
(Ing. Francesco Capuano)